



KURSAAL
DONOSTIA SAN SEBASTIAN

Convention Centre • Auditorium

SAN SEBASTIAN



The city
Culture | Leisure | Gastronomy
Location | Accommodation
Surroundings

4



KURSAAL



Innovation | Avant-garde
Quality | Awards

12



SPACES



Auditorium
Chamber Hall
Meeting rooms
Exhibition Halls

16



RESTAURANTS



26



SERVICES



28



KURSAAL
DONOSTIA SAN SEBASTIAN

Convention Centre • Auditorium

San Sebastian





The city | 6

Culture | Leisure | Gastronomy | 8

Location | Accommodation | 9

Surroundings | 10



San Sebastian

San Sebastian is a traditional and well-known destination for tourists and over the last few decades for conventions as well. The city has settled around the unique bay of La Concha (the Shell), and on the banks of the mouth of the river Urumea. Within the same district, mountains and beaches shape an exceptional display of urban scenery combining carefully tended architectural features with a unique natural landscape.

San Sebastian is a city to enjoy by foot. The Kursaal is located in the very heart of the city, facing the sea and Zurriola beach.



Culture Leisure Gastronomy



The romantic, historic part of San Sebastian lives in perfect harmony with the new more modern vanguard style of the City. New equipment and infrastructures strengthen its dynamic and innovative image, which conserves and pampers its neighbourhoods and historical buildings.

Throughout the year, the programme of shows, exhibitions and festivals make San Sebastian an indisputable reference on the international culture stage. Regarding sports, the options ranges from surfing to sailing, golf or horse-riding, with out forgetting to mention more relaxing activities such as thalassotherapy.

Leisure time is also complemented with another undeniable value: gastronomy. How the Basques worship this art is best reflected in San Sebastian which has been awarded more Michelin guide stars than any place in the world and offers a wide variety of restaurants and bars serving up top chefs' star dishes alongside miniature haute cuisine in the form of pintxos (appetizer).





- ¥ San Sebastian is a coastal city.
- ¥ Situated in the Basque Country, less than 100 kilometres from Bilbao and 40 from the French city of Biarritz.
- ¥ With just over 180,000 inhabitants, it is connected both nationally and internationally by a vast network of motorways.
- ¥ It has a high speed rail link and five airports within a one hundred kilometre radius.
- ¥ San Sebastian has 3,600 hotel beds within the city centre.

Airports

- ¥ San Sebastian (20 minutes away by motorway)
- ¥ Bilbao (55 minutes away by motorway)
- ¥ Biarritz (30 minutes away by motorway)
- ¥ Vitoria (60 minutes away by motorway)
- ¥ Pamplona (50 minutes away, by motorway)



Location Accommodation



SAN SEBASTIAN





In Gipuzkoa and the Basque Country as a whole, an outstanding balance has been achieved between rural and industrial settings. Concern for the environment and the quality of the services and infrastructures offered, all contribute to the high standard of living enjoyed by all citizens in Gipuzkoa which, in turn, is offered to its visitors.

Reasons to discover the Basque Country?

Immersing yourself in genuine Basque idiosyncrasy and getting to know villages hidden away between mountains and valleys, visiting antique and avant-garde wineries and strolling through extensive vineyards, seeing the wild coastline with picturesque villages, discovering historical town centres or examples of the most modern architecture such as the Guggenheim Museum in Bilbao.



Kursaal



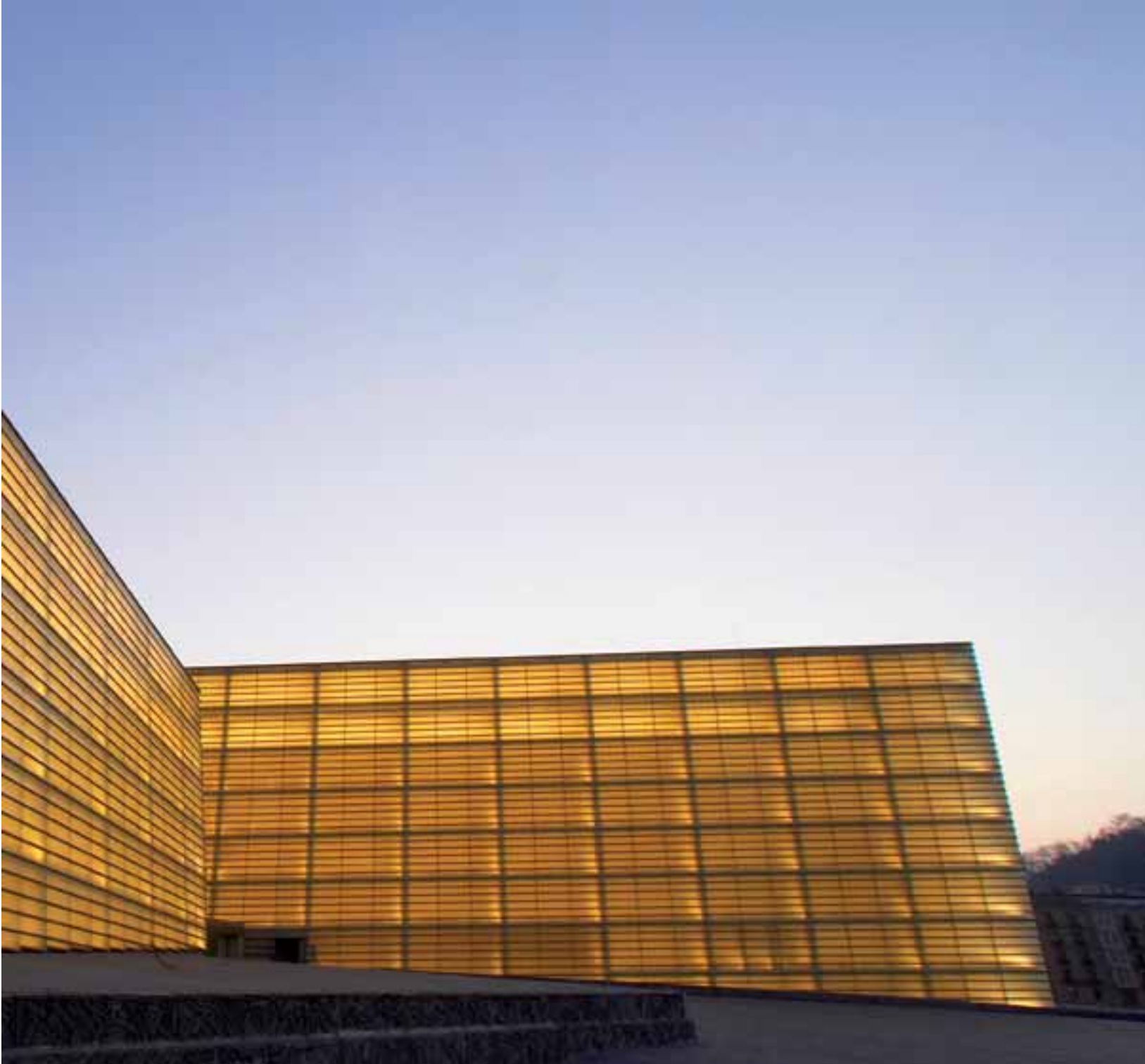

Innovation | Avant-garde | 14

Quality | Awards | 15

Innovation Avant-garde



The innovative nature of Kursaal is apparent both in its original architectural design and its infrastructure offering functionality and versatility.

Designed by Rafael Moneo, the building is a synthesis of artistic creativity and the artist's ability to combine the most advanced modern technologies and offer them in the equipment required to organise events.

The avant-garde nature of this intelligent building is clear combining conceptual, aesthetic, technical and constructive innovation.

The most highly acclaimed Convention Hall in Europe

Demonstrated experience and commitment to continuously improving service quality make choosing Kursaal to hold any type of event a guarantee for success. This accomplishment includes the surroundings, equipment, human team and effort to provide a job well done. We work on this quality everyday, looking after even the smallest details - it is the first convention hall to be accredited total accessibility - which has been recognised as the Kursaal has been the worthy winner of several distinctions.



■ Recognition for its management

- ¥ISO 14001:2004 Environmental Management Certificate° (2008)
- ¥ISO 17001:2001 Global Accesibility Certificate (2007)
- ¥Gold Certificate awarded by AIPC (International Convention Hall Association) 2007
- ¥Silver Q — EFQM (2005)
- ¥ISO 9001:2008 Certificate (2001)

■ Marketing awards

- ¥ESADE Brand Centre Award (2005)
- ¥26th Alpha Award for Excellence in Marketing (2004)
- ¥Best Marketing Award (2003) awarded by ICCA (International Congresses and Conventions Association)

■ Architecture awards

- ¥Best European Building (2001)
- Mies Van der Rohe Prize awarded by the European Union
- ¥Manuel de la Dehesa Award (2001), for the 6th Spanish Architecture Biennial
- ¥FAD Architecture award (2000)

Unlimited
space





Auditorium | 18

Chamber Hall | 20

Meeting rooms | 22

Exhibition Halls | 24



Characteristics of the room

- ¥Seating capacity of 1,806
- ¥Convertible into 1,148 seats
- ¥Equipped with the latest technology
- ¥Stage with maximum functions
- ¥Perfect for cultural events, as well as congresses, conventions, large meetings, etc.
- ¥Foyer - hall
- ¥2 VIP rooms
- ¥Congress bar
- ¥Independent access





Chamber Hall

Characteristics of the room

- ¥Seating capacity of 624
- ¥Equipped with the latest technological services.
- ¥Ideal for congresses, conventions or medium sized meetings as well as for chamber orchestra concerts
- ¥VIP room
- ¥Independent access





Characteristics of the rooms

¥Multi-purpose modular spaces

¥20 rooms with capacity for between 10 and 575 people

¥Latest technological equipment

¥Hall for coffee-breaks

¥Bar

¥Rooms suitable for all sizes of events:
assemblies, conventions, sessions, training
seminars, product presentations, etc.

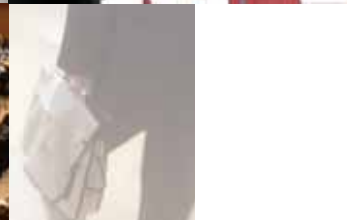



Characteristics of the spaces

¥ 5,000 m² of exhibition space

¥ 2 open-air terraces offering 5,000 m² with sea views

¥ Appropriate spaces for exhibitions, fairs, product presentations, etc.





Restaurant Service

One distinguishing feature of the Kursaal Centre is its excellent cuisine. Heading the team is chef Andoni Luis Aduriz, currently ranked the fourth best restaurateur in the world and holder of two Michelin stars. Aduriz has joined forces with Bixente Arrieta, both managing partners at the Ixo Group — in charge of running the Kursaal restaurants. The two have combined their creativity and know-how to ensure a memorable dining experience.

Using only the finest ingredients available, the Kursaal offers a variety of options ranging from a haute cuisine lunch to a light, relaxed bistro-style evening meal in the two areas of the **ni neu** restaurant. Visitors can also enjoy a 1,500 guest banquet in the Banquet Hall, a coffee break with a difference, a cocktail reception for up to 1,800 people in the bright, modern vestibule-foyer, or pintxos on the terrace with views overlooking the sea.





The Kursaal offers personal attention, exclusive dedication and an integral service concept which stands out for its flexibility and capability to keep on top of all the details and needs which occur when organising an event.

An expert human team participates actively both in the project and in producing the event and manages a wide offer of services, from audiovisuals, stage lighting or renting material to providing technical personnel and hostesses, simultaneous translation or piano rental. There is also an option to contract a la carte services, including all the technical and human resources to guarantee the event or celebration will be a success.

These features are complemented by convenient parking facilities with capacity for 500 vehicles or the centre's commercial area both guaranteeing perfect results for all types of events allowing your event to live up to your expectations.



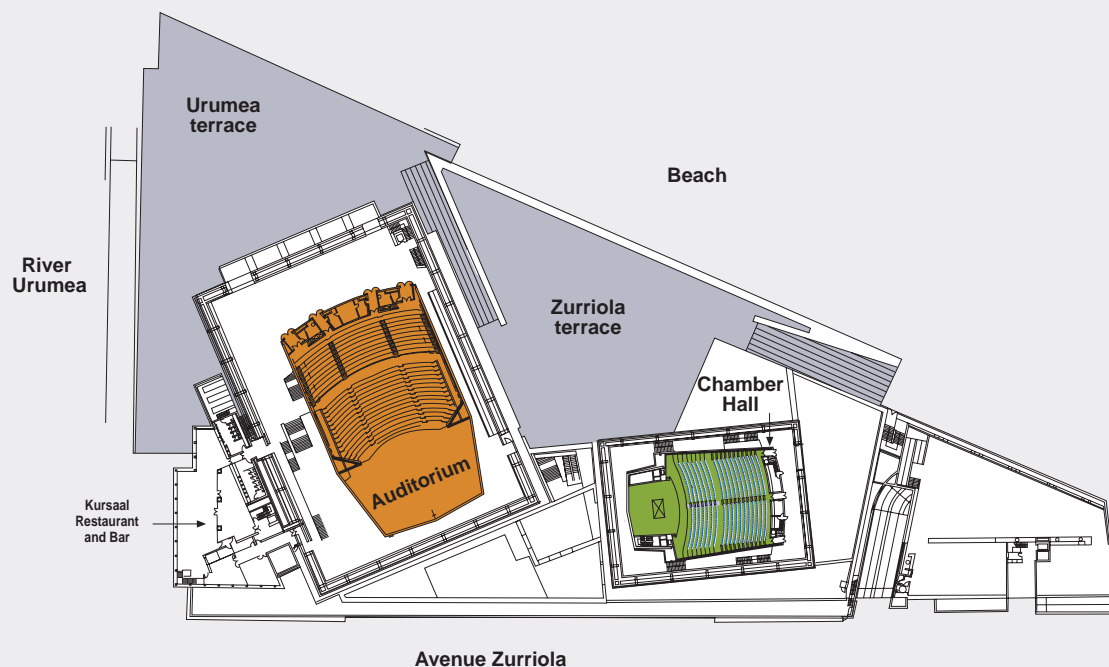

- ✂Hostesses
- ✂Stage, lighting and audiovisual technicians
- ✂Camera operators
- ✂Surveillance
- ✂Cleaning service
- ✂Medical assistance
- ✂Simultaneous translation
- ✂Services for people with disabilities
- ✂Rental of audiovisual and stage material
- ✂Piano rental
- ✂Car park
- ✂Commercial area

Auditorium



 Auditorium	
Capacity	¥ Stalls: 1,806 - Dress circle: 1,148 - Upper circle: 552 - Balconies: 106
Stage measurements	¥ 350 m ² equipped with acoustic shell and complete range of stage machinery ¥ Proscenium: - Width: 20 metres - Height: 10 metres - Flyloft height: 21 metres ¥ Stage depth: 15.50 metres ¥ Apron: 1.15 metres
Orchestra pit	¥ 100 m ²
Cinema screen measurements	¥ 18,3 x 9,3 metres
General characteristics	¥ 1 dressing rooms: 6 individual and 5 for groups ¥ 2 multi-purpose rehearsal rooms ¥ 1 dance rehearsal room ¥ 2 VIP rooms ¥ Cloakroom ¥ Bar

  Technical characteristics		Auditorium Chamber Hall
	¥ Audiovisual media: - Sound and lighting cabin - Public address systems - Fixed and cordless microphones - Infrared simultaneous interpretation systems - 5 (A) 6 (C.H.) simultaneous interpretation booths - Playing/recording systems for audio, DVD, CD, DAT and mini-disc - Videoconference equipment - Videoprojection system and video screen ¥ Projection cabin and cinema screen - 3D Digital Film System - Dolby Digital, SDDS and DTS cinema sound system ¥ Voice and data network, RDSI, ADSL, connection etc. ¥ WIFI ¥ Lighting system for shows on the stage and in spot light galleries ¥ Intercom communication system ¥ Stage (A): - Acoustic shell - Stage blacks - Complete stage machinery	

Chamber Hall

 Chamber Hall	
Capacity	¥ Stalls: 624
Stage measurements	¥ 120 m ² with removable acoustic ceiling and complete range of stage machinery ¥ Proscenium: - Width: 11.50 metres - Height: 6.70 metres
Cinema screen measurements	¥ 10 x 8,5 metres
General characteristics	¥ 5 dressing rooms: 3 individual and 2 for groups ¥ 1 VIP room ¥ Cloakroom

Meeting rooms

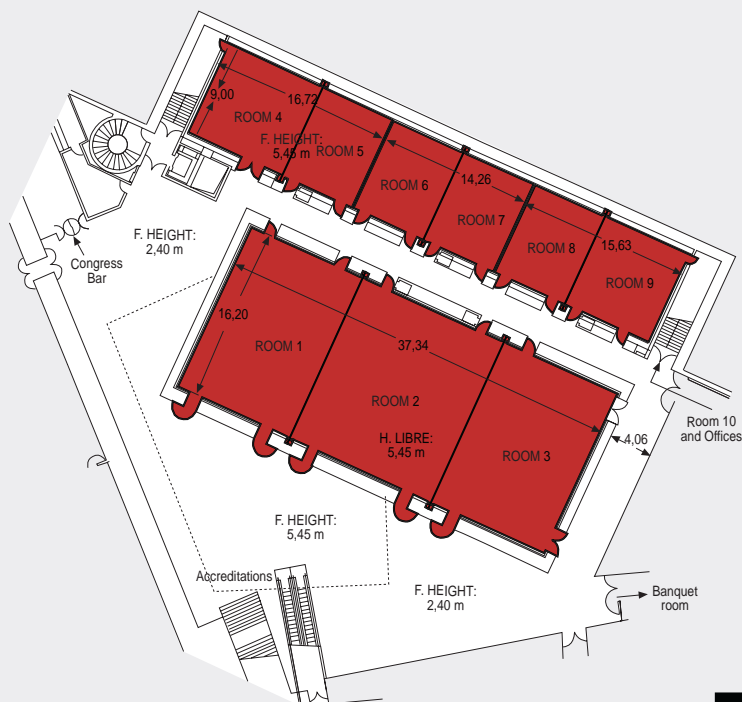

Meeting rooms	
Technical characteristics	<p>¥ Audiovisual media:</p> <ul style="list-style-type: none"> - Loudspeaker system - Fixed and cordless microphones - Infrared simultaneous interpretation systems - 6 simultaneous translation booths - Playing/recording systems for audio, DVD, CD, DAT and mini-disc - Video projection system - Videoconference <p>¥ Data and voice network, connection via RDSI, ADSL, etc.</p> <p>¥ WIFI</p>



	Theatre	Class	U	O	M²	L x H	Height	Level
Room 1	150	84	48	60	182	11,40 x 16,20	5,45	-1
Room 2	200	126	54	72	231	14,26 x 16,20	5,45	-1
Room 3	150	84	48	60	182	11,40 x 16,20	5,45	-1
Room 1+2/2+3	395	252	84	102	413	25,66 x 16,20	3,75	-1
Room 1+2+3	575	378	120	138	595	37,34 x 16,20	3,75	-1
Room 4	60	45	27	36	86	9,52 x 9,00	5,45	-1
Room 5	40	36	24	30	64	7,06 x 9,00	5,45	-1
Room 4+5	110	81	51	54	150	16,72 x 9,00	3,75	-1
Room 6	40	36	24	30	64	7,06 x 9,00	5,45	-1
Room 7	40	36	24	30	64	7,06 x 9,00	5,45	-1
Room 6+7	90	63	39	48	128	14,26 x 9,00	3,75	-1
Room 8	40	36	24	30	64	9,52 x 9,00	5,45	-1
Room 9	50	36	27	30	86	7,06 x 9,00	5,45	-1
Room 8+9	100	72	45	54	140	15,63 x 9,00	3,75	-1
Room 10	173	120	51	57	210	17,50 x 10,50	3	0
Room 10A	65	48	33	36	90	7,30 x 12,00	3	0
Room 10B	28	18	21	24	41	7,70 x 5,20	3	0
Room 10C	28	18	21	24	40	7,70 x 5,10	3	0
Room 10B+C	60	45	30	36	82	7,70 x 10,40	3	0
Chamber Hall VIP room	25	¥	10	¥	39	7,25 x 7,70	2,80	0
Auditorium VIP room 1	25	¥	10	¥	38	6,37 x 7,38	2,80	1
Auditorium VIP room 2	25	¥	10	¥	39	5,92 x 7,08	2,80	1

Exhibition Halls

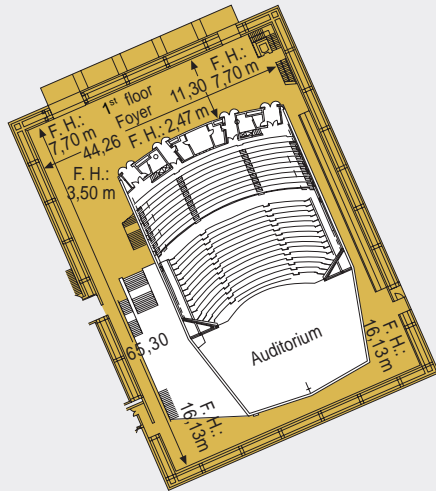

Auditorium Foyer
Level 1
1,200 m²

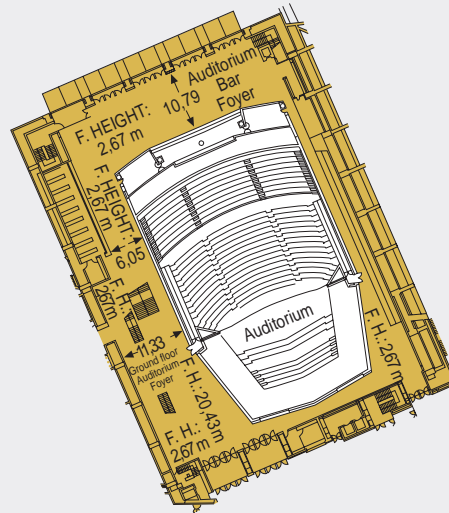

Auditorium Foyer
Level 0
1,300 m²

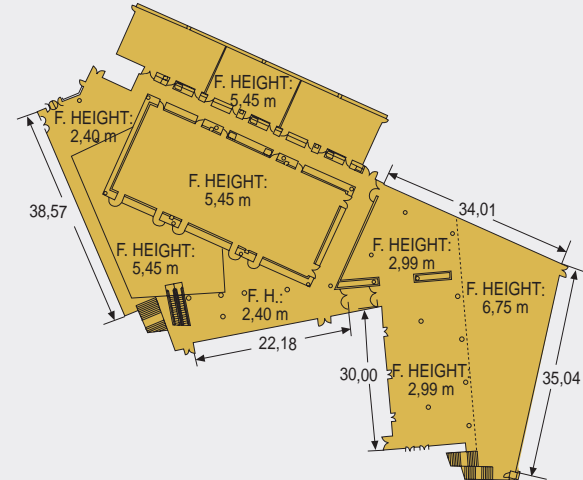

Floor -1
3,500 m²

Terraces

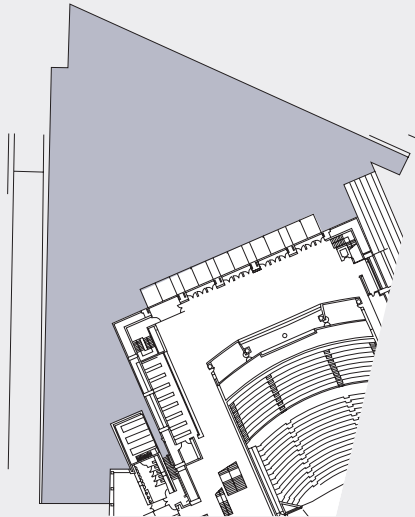

Urumea terrace
Level 0
3,000 m²

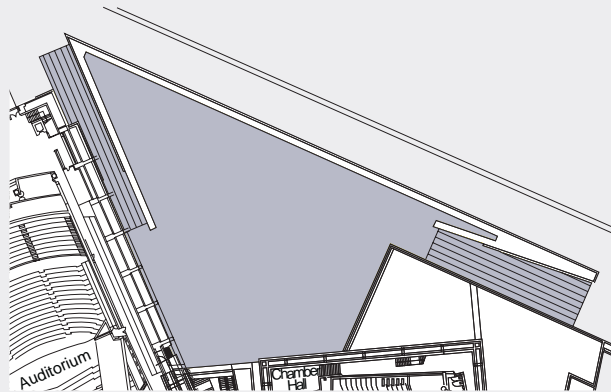

Zurriola terrace
Level 1
2,150 m²

		Exhibition Halls Terraces
Characteristics	Space for exhibitions, product presentations, setting up stands, etc.	

Restaurant areas

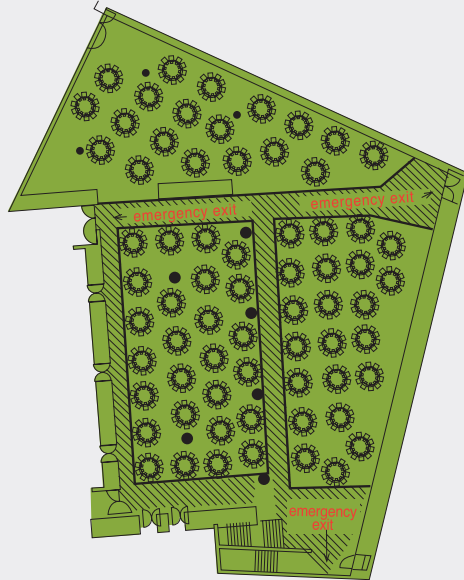

Banquet rooms

1,100 m²

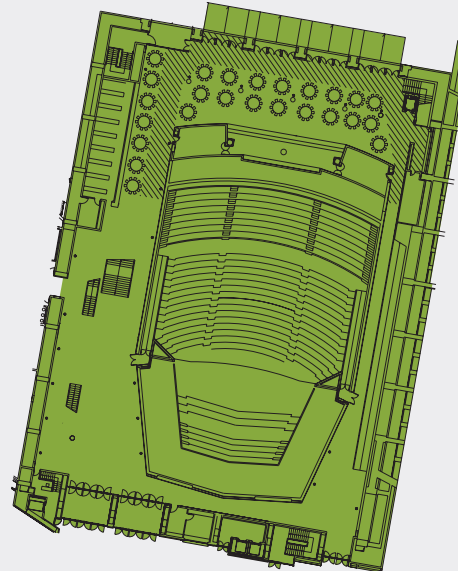

Auditorium Foyer

Level 0

1,200 m²

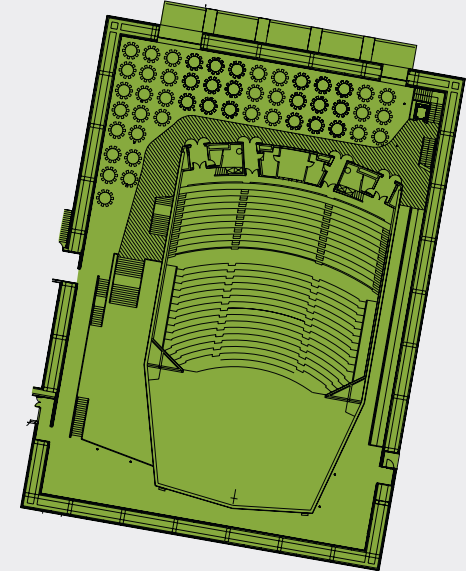

Auditorium Foyer

Level 1

1,200 m²

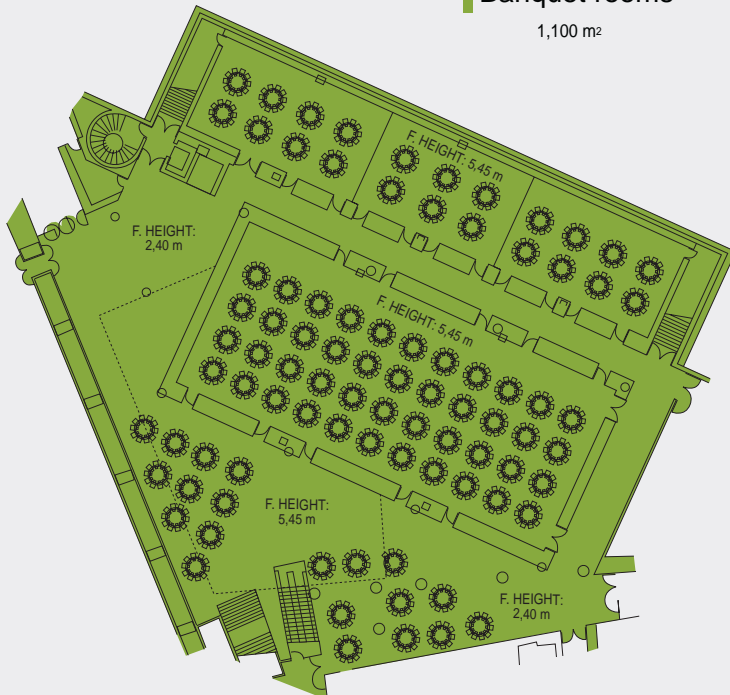

Meeting rooms

1,400 m²

	 Banquet	 Cocktail	 M ²	 L x H	 Height	 Level
Banquet room	770	770	1,100	35,00 x 34,00	2,99/6,75	-1
Meeting Rooms Hall	¥	600	1,000	¥	2,40/2,99	-1
Banquet room + Meeting rooms	1,500	1,500	2,500	¥	¥	-1
Auditorium Foyer (Ground floor +1 st floor)	1,000	1,800	2,500	62,00 x 41,00 x 2	2,47/2,67/7,70	0
1 st floor Auditorium Foyer	450	800	1,200	62,00 x 41,00	2,47/7,70	+1





KURSAAL

DONOSTIA SAN SEBASTIAN

Convention Centre • Auditorium





*Avda. de Zurriola, 1
20002 Donostia-San Sebastián
Tel.: +34 943 003 000
Fax: +34 943 003 001
kursaal@kursaal.org*

www.kursaal.org